

BUILD Your Own

# Robotic Beeper

Instruction Manual

**COOL**<sup>TM</sup>  
Science

FOR AGES 6+

*Easy to  
assemble*

*Build your  
own energy  
converter*



P38-CS009-81001001



# WARNING:

**CHOKING HAZARD - Small parts.  
Not for children under 3 years.**

**NOT RECOMMENDED FOR CHILDREN UNDER 6 YEARS OF AGE. TOYS CONTAINS SMALL PARTS AND FUNCTIONAL SHARP EDGES ON ELECTRONIC COMPONENTS. USE UNDER THE DIRECT SUPERVISION OF AN ADULT. KEEP AWAY FROM CHILDREN UNDER 3 YEARS.**

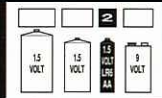

Requires 2 x AA batteries.  
Batteries not included.  
Do not use rechargeable batteries.  
Non-rechargeable batteries are not to be recharged.  
Rechargeable batteries are to be removed from the toy before being charged.  
Rechargeable batteries are only to be charged under adult supervision.  
Different types of batteries or new and used batteries are not to be mixed.  
Only batteries of the same or equivalent type as recommended are to be used.  
Batteries are to be inserted with the correct polarity.  
Exhausted batteries are to be removed from the toy.  
The supply terminals are not to be short-circuited.

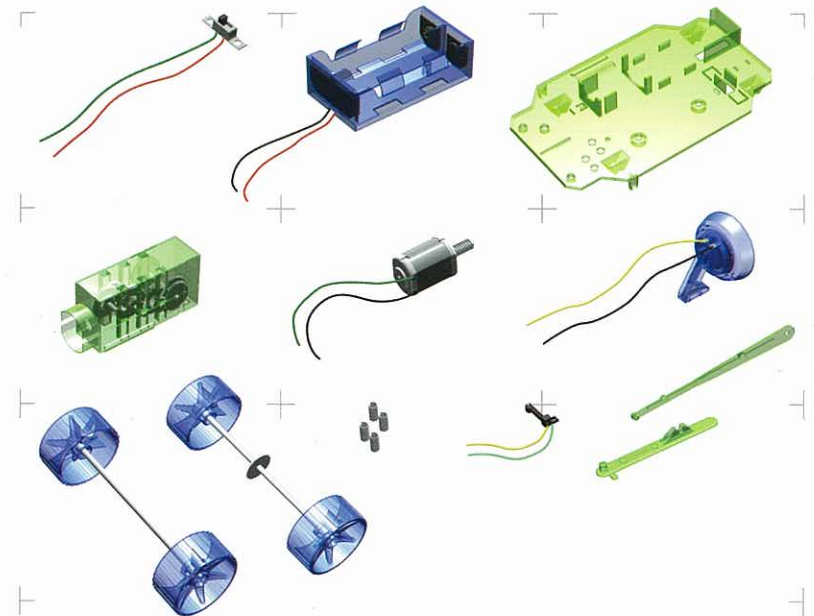

- 4 x Wire Springs
- 1 x On / Off Button
- 1 x Gear Box
- 1 x Chassis
- 1 x Leaf Switch
- 1 x Slide Switch
- 2 x Electrical Wire (Red)
- 3 x Electrical Wire (Black)
- 3 x Electrical Wire (Green)
- 2 x Electrical Wire (Yellow)
- 1 x Motor with Wires
- 1 x Battery Box
- 2 x Axial
- 2 x Pushing Rod
- 4 x Wheels
- 1 x Buzzer



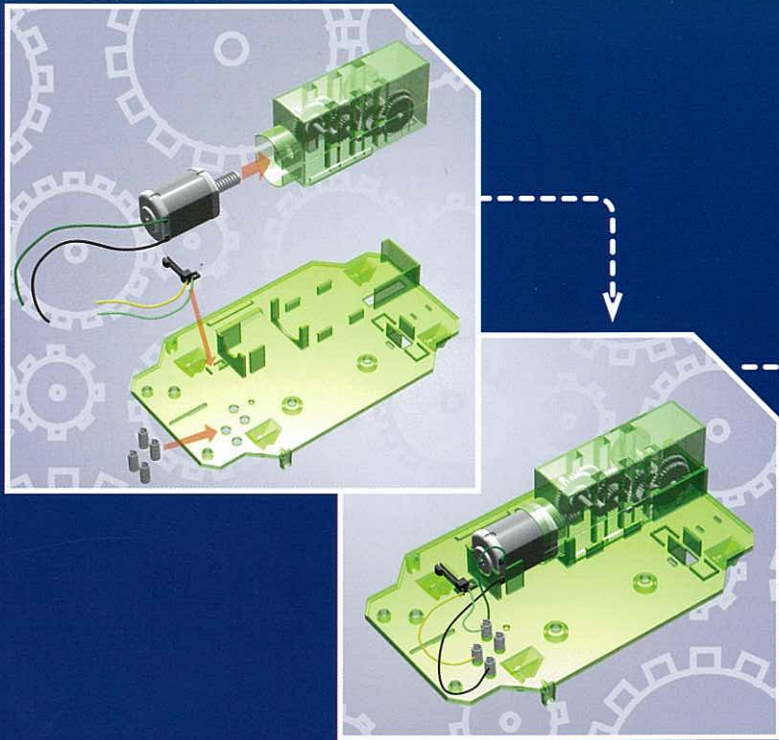

4

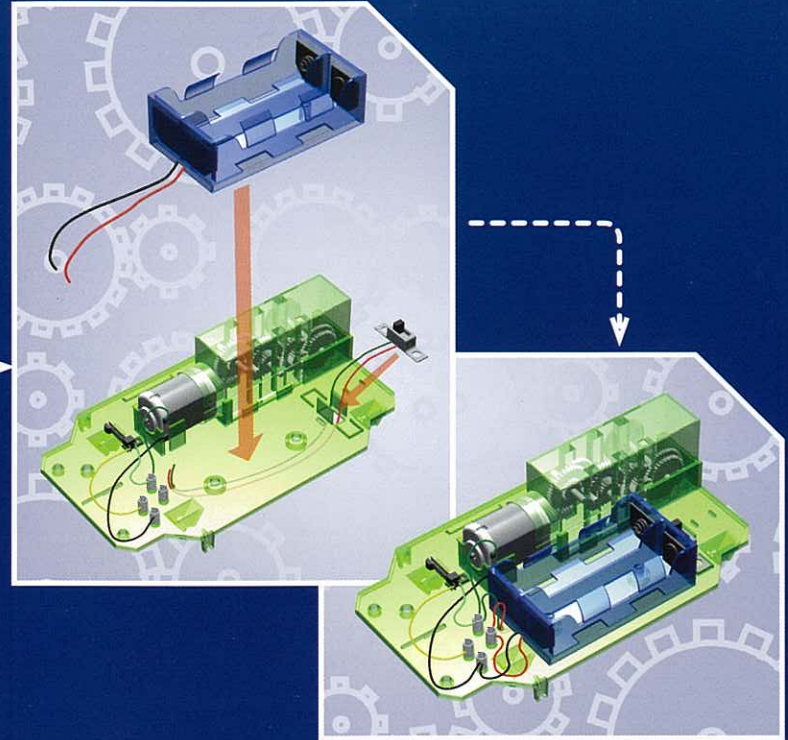

5

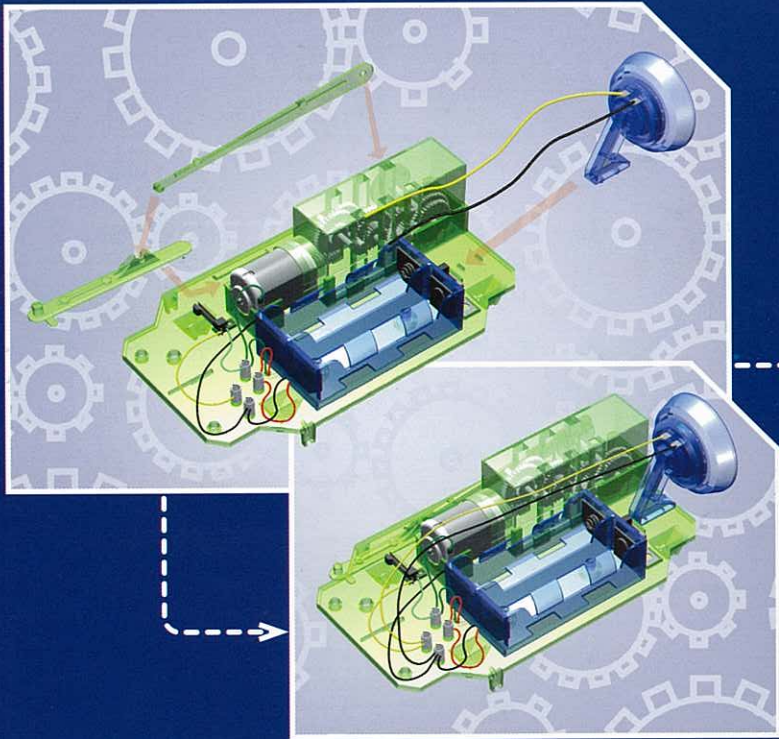

6

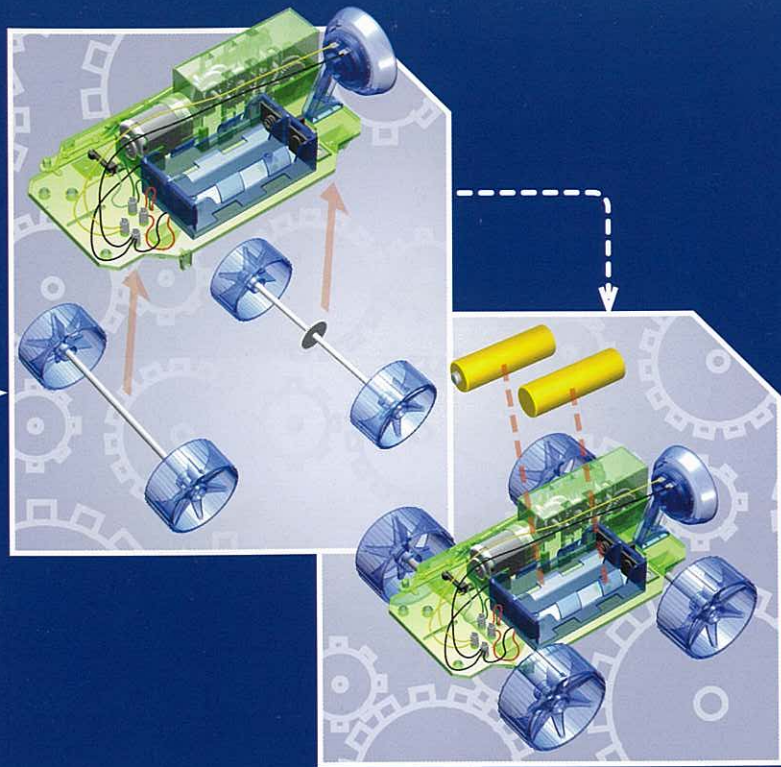

7